



**Fox Close, Abbeymead, Gloucester GL4 5YH**

**£277,950** Freehold



**MICHAEL TUCK**

The Agent with 5 star customer service

**15 Fox Close, Abbeymead, Gloucester,  
Gloucestershire, GL4 5YH**

**£277,950**

Freehold. Council Tax Band C



**3 Bedrooms**



**2 Bathrooms**



**2 Receptions**

#### Features

- \* LINK-DETACHED
- \* 3 BEDROOMS
- \* NICE SIZE GARDEN
- \* GARDEN
- \* CLOAK ROOM
- \* UPVC DOUBLE GLAZING
- \* VIEWING STRONGLY ADVISED
- \* EPC D COUNCIL TAX BAND C

#### Michael Tuck Estate and Letting Agents

2 Mead Road Abbeymead Gloucester Gloucestershire GL4 5GL

01452 612020

[estates.abbeymead@michaeltuck.co.uk](mailto:estates.abbeymead@michaeltuck.co.uk)

[www.michaeltuck.co.uk](http://www.michaeltuck.co.uk)

#### The Property

\*\*\* WELL PRESENTED 3 BEDROOM LINK-DETACHED, GREAT SIZE GARDEN, GARAGE & OFF ROAD PARKING \*\*\* Michael Tuck Estate Agents are delighted to welcome to the market this very well presented 3 bedroom link-detached property, located at the end of a sought after cul-de-sac in the heart of Abbeymead. This much loved home has been currently extremely well maintained by its current owners over the last 30 years boasts many benefits for the young family or first time buyers. The accommodation comprises of: Entrance hall, cloakroom, lounge/diner & kitchen. Upstairs are three bedrooms & bathroom suite. Outside to the rear we have a generous size garden with GARAGE & DRIVEWAY also included. The property is both centrally located, yet tucked away, and enjoys great access links to all local amenities, bus routes. We're anticipating keen interest, so please be quick to view! Call us today on 01452 612020 to arrange your viewing, you'll not be disappointed! Offered For Sale by Michael Tuck Estate Agents, Abbeymead, Gloucester.

#### Entrance Hall

#### Cloakroom

**Lounge** 13' 0" x 11' 9" (3.95m x 3.59m)

**Dining area** 12' 0" x 7' 1" (3.67m x 2.17m)

**Kitchen** 10' 7" x 7' 0" (3.23m x 2.13m)

**Bedroom 1** 10' 6" x 8' 8" (3.21m x 2.63m)

**Bedroom 2** 10' 9" x 7' 3" (3.28m x 2.20m)

**Bedroom 3** 7' 2" x 6' 6" (2.19m x 1.97m)

#### Family Bathroom











GROUND FLOOR

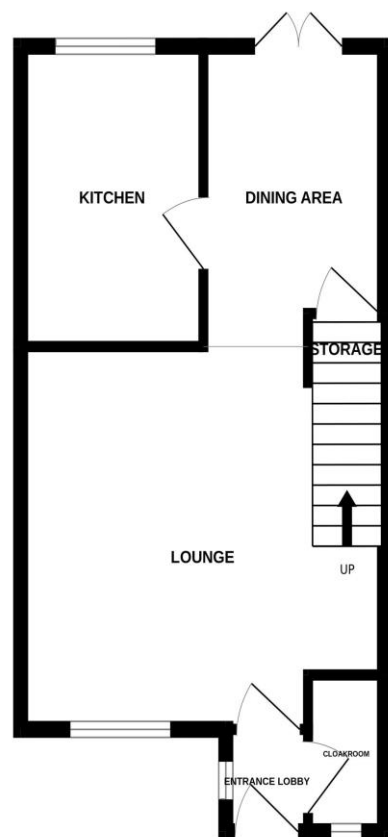

1ST FLOOR

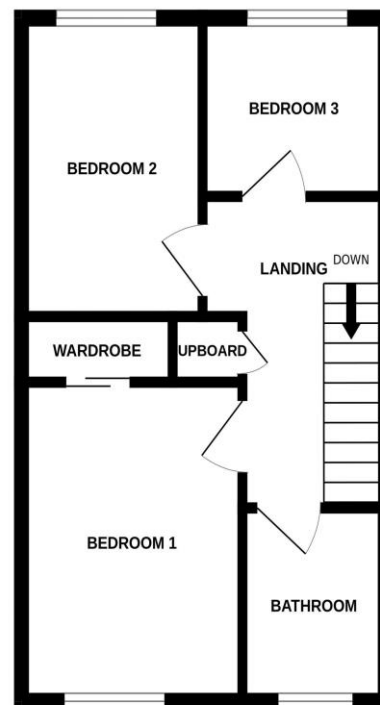

### FOR ILLUSTRATIVE PURPOSES ONLY – NOT TO SCALE

The position and size of doors, windows, appliances, and other features are approximate only.  
Unauthorised reproduction prohibited

**Important notice:** Michael Tuck, its clients and any joints give notice that 1: They are not authorised to make or give any representations or warranties in relation to the property either here or elsewhere, either on their own behalf of their client or otherwise. They assume no responsibility for any statement that may be made in these particulars. These particulars do not form part of any offer or contract and must not be relied upon as statements or representation of fact. 2: Any areas, measurements or distances are approximate. The text, photographs and plans are for guidance only and are not necessarily comprehensive. It should not be assumed that the property has all necessary planning, building regulation or other consents and Michael Tuck have not tested any services, equipment or facilities. Purchasers must satisfy themselves by inspection or otherwise.

